

Come home to a Walker home

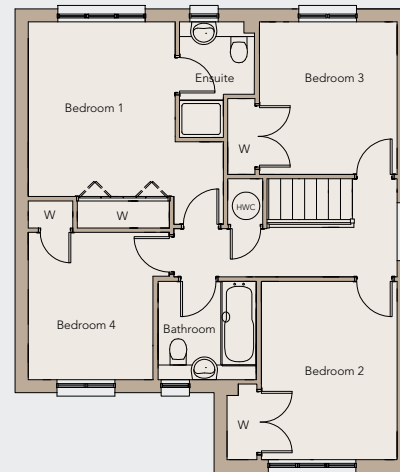

Find out more at www.walkergroup.co.uk
or contact 01506413101

Collingwood
Cumbernauld

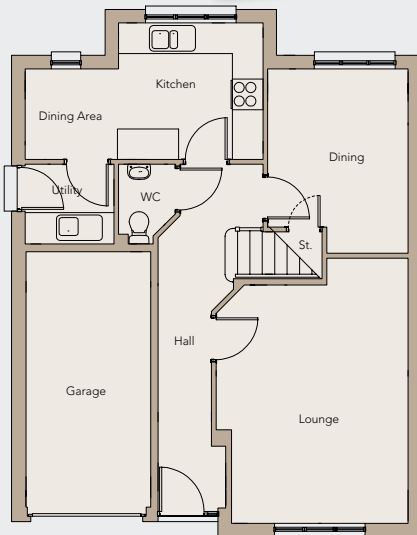

GROUND

	Metric	Imperial
Kitchen	2.83 x 2.67	9'3" x 8'9"
Lounge	3.76 x 5.19	12'4" x 17'1"
Dining	2.75 x 3.63	9'0" x 11'10"
Dining Area	1.83 x 1.77	6'0" x 5'10"
Utility	1.74 x 1.56	5'9" x 5'2"
Garage	2.44 x 5.00	8'0" x 16'8"

FIRST

	Metric	Imperial
Bedroom 1	3.00 x 3.55	9'10" x 11'7"
Bedroom 2	2.76 x 3.63	9'0" x 11'11"
Bedroom 3	2.80 x 3.10	9'2" x 10'2"
Bedroom 4	2.54 x 3.00	8'4" x 9'10"

Disclaimer: Grange Estates and Walker Group give notice that: (1) the specification and materials may vary from those shown; (2) all descriptions, dimensions, references to condition and necessary permissions for use and occupation, and other details are given without responsibility and any intending purchasers should not rely upon them as statements or representations of fact but must satisfy themselves by inspection or otherwise as to the correctness of each of them and are advised to do so; (3) all images and other visuals shown are for illustrative purposes only; (4) although every care has been taken to ensure the accuracy of all information, contents do not form part nor shall be deemed to form part of, or constitute, a representation warranty, or part of any contract.

